



Fresno County Department of Agriculture
1730 S. Maple Avenue
Fresno, CA 93702

Office: 559-600-7510
Email: Fresnoag@fresnocountyca.gov

Fax: 559-455-4650
Web: www.fresnocountyca.gov/departments/agricultural-commissioner

Operator Identification Number 10-22-1041061

Operator: PARICHAN FARMS
8344 RD 33
MADERA, CA 93638

Agent: PARICHAN, REID
3486 E BLANCHARD AVE
LATON
CA 93242

Certified Applicator: PARICHAN, ROD
8107 S LASSEN AVENUE
SAN JOAQUIN, CA 93660

1041061-2022-Version: 1
County District #:4
Issued on:1/12/2022
Valid as of:1/11/2022
Expires on:12/31/2022
Primary Phone: (559) 674-9839
Alternate Phone:
Mobile Phone: (559) 285-1073
Fax:
Phone:(559)242-2092
License #:200096
Expiration:12/31/2022

Type of Use: Agricultural Use

Employees Handle Pesticides

Regulatory Notes:

I understand this operator identification number does not relieve me from liability for any damage to persons or property caused by the use of pesticides. I acknowledge that duly authorized representatives from the County Department of Agriculture or the Department of Pesticide Regulation may, at reasonable times, enter and inspect fields, areas, structures, greenhouses and equipment (including protective clothing and equipment) where pesticides are handled, stored or applied (ref. 3 CCR 6140).

[Form PR-ENF-125 (Rev 11/06) Pesticide Enforcement Branch]

Applicant: Reid R Parichan, Owner

(Name & Title)

Applicant Signature: Reid Parichan

Date: January 12 2022

Issuing Officer: [Signature]

Date: 1-12-2022

CONTACT LIST

<u>Name</u>	<u>Auth Rep.</u>	<u>Phone</u>	<u>License</u>	<u>Expiration</u>	<u>Contact Type</u>
PARICHAN, REID	yes	(559) 285-1073			Authorized Representative
PARICHAN, ROD	yes	(559) 242-2092	200096	12/31/2022	Private Applicator Certificate

PESTICIDES LIST

<u>Number</u>	<u>Pesticide</u>	<u>Pests</u>	<u>Forms</u>	<u>Methods</u>	<u>Applicators</u>
---------------	------------------	--------------	--------------	----------------	--------------------

SITES REQUIRING SCHOOLSITE NOTIFICATION

There are currently no sites requiring schoolsite notification
 List current as of 01/12/2022 - check with the County Agricultural Commissioner's Office for an updated list.

SITES LIST

<u>Site</u>	<u>Location Site Name</u> <u>Commodity Name/Code</u>	<u>Quantity</u>	<u>District</u>	<u>Section (MTRS)</u>
401	GWPA: NONE NW BLANCHARD/PEACH GRAPE, WINE / 29143-0	47 ACRES	4	M17S21E18
402	GWPA: NONE NW COLEMAN/PEACH ALMOND / 3001-0	65 ACRES	4	M17S21E07
404	GWPA: NONE NE COLEMAN/CHESTNUT GRAPE / 29141-0	25 ACRES	4	M17S21E07
404W	GWPA: NONE SW COR DAVIS/CHESTNUT ALMOND / 3001-0	45 ACRES	4	M17S20E12
411	GWPA: NONE NW COLEMAN/PEACH ALMOND / 3001-0	90 ACRES	4	M17S21E07
412	GWPA: NONE NW COLEMAN/PEACH ALMOND / 3001-0	239 ACRES	4	M17S21E07
412W	GWPA: NONE SW COR DAVIS/CHESTNUT ALMOND / 3001-0	8 ACRES	4	M17S20E12

PARICHAN FARMS

Expires: 12/31/2022

414	GWPA: NONE 3/4 MI. S DAVIS/ 1/2 MI W. PEACH ALMOND / 3001-0	30 ACRES	4	M17S21E07
-----	--	----------	---	-----------

415	GWPA: NONE NW CORNER 17S21E07 ALMOND / 3001-0	40 ACRES	4	M17S21E07
-----	--	----------	---	-----------

416	GWPA:NONE S OF DAVIS & 1.5 MILE W OF CEDAR ALMOND / 3001-0	20 ACRES	4	M17S21E07
-----	---	----------	---	-----------

OPERATION-WIDE CONDITIONS



Fresno County		Permit Number: 1041061
MAP 1		Created On: 1/12/2022
NE CHESTNUT - BLANCHARD		Operator: PARICHAN FARMS

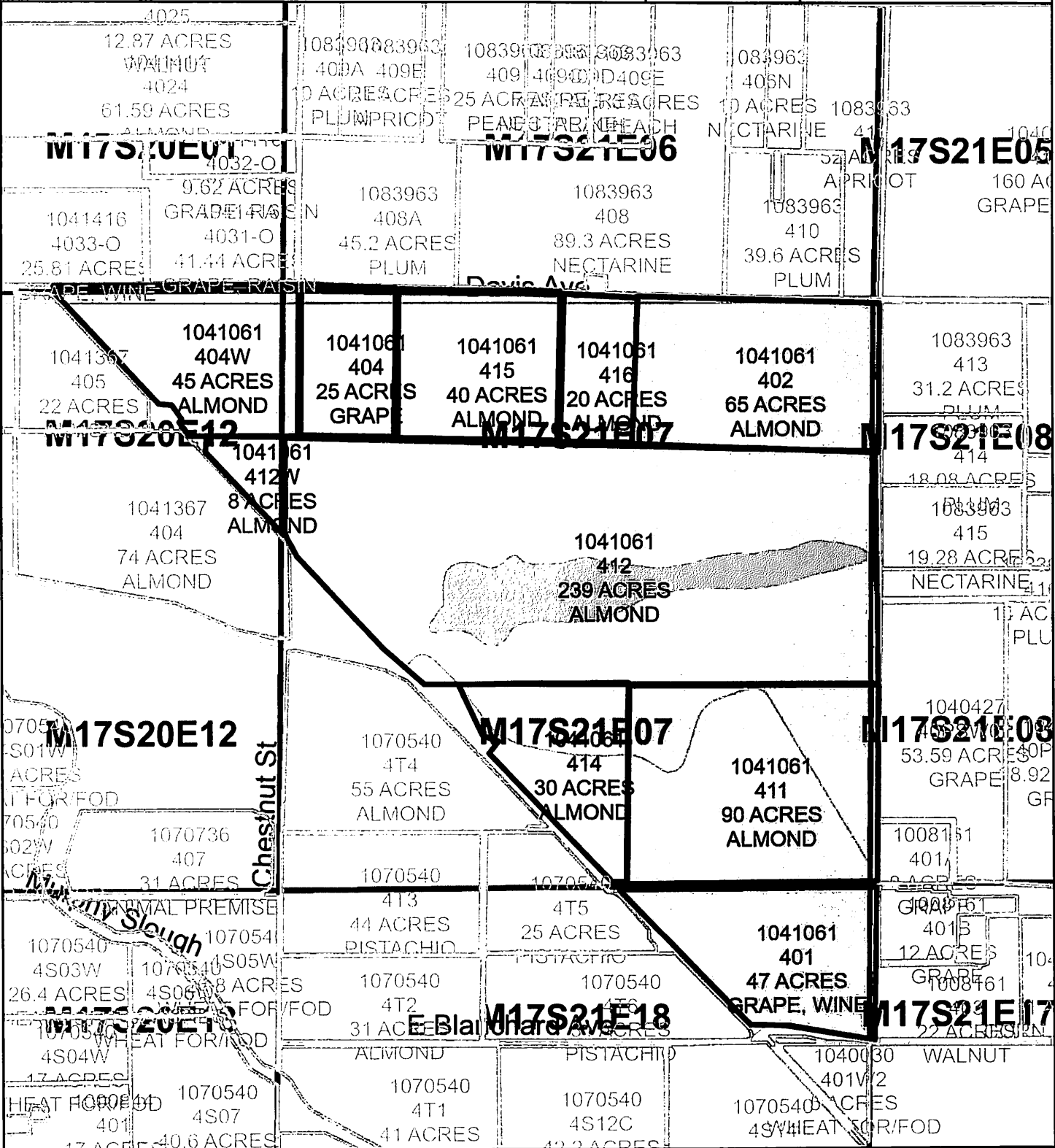

Included Sites:	401, 402, 404, 404W, 411, 412, 414, 415, 415W, 416	
------------------------	--	--